

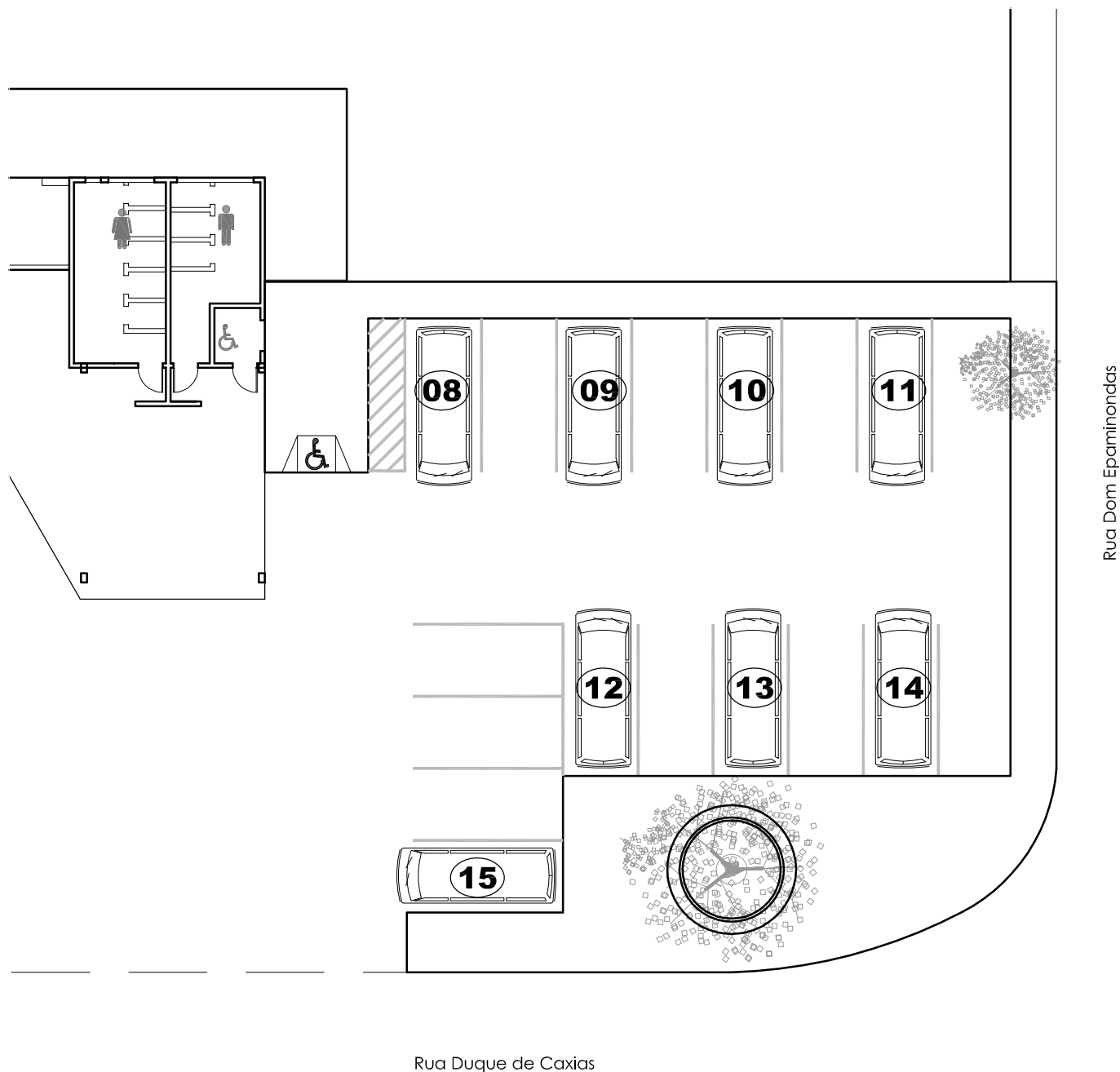

Prefeitura Municipal de Roseira

Praça Santana, 201 - Centro - Tel.(12) 3646-9900 e 3646-9904
CEP 12580-000 - CNPJ 45.212.008/0001-50 - ROSEIRA - SP

Anexo II Carnaval 2020 / Roseira



TERMINAL RODOVIÁRIO

ESCALA GRÁFICA

